

RECLAMATION

Managing Water in the West

Categorical Exclusion Checklist

Shasta-Cascade Retriever Club and Sierra Nevada Retriever Club Field Trials

LO-2015-1016 and LO-2015-1000

Prepared by:



Julia Long
Natural Resources Specialist
Mid Pacific Region
Lahontan Basin Area Office

Date: 5-19-15

Concurred by:

See Attachment A

Archaeologist
Mid Pacific Regional Office
Environmental Affairs Division

Date: See Attachment A

Concurred by:

See Attachment B

Native American Affairs Program Manager
Mid Pacific Regional Office
Division of Resources Management

Date: See Attachment B

Recommended by:



Rena Ballev
Resources Division Manager
Mid Pacific Region
Lahontan Basin Area Office

Date: 5-20-15

Approved by:



Terri A. Edwards
Area Manager
Mid Pacific Region
Lahontan Basin Area Office

Date: 5/20/15



[This page intentionally left blank.]

BUREAU OF RECLAMATION
CATEGORICAL EXCLUSION CHECKLIST
Mid-Pacific Region - Lahontan Basin Area Office

Project Name: Shasta-Cascade Retriever Club and Sierra Nevada Retriever Club Field Trials

CEC Number: LO-2015-1016 and LO-2015-1000

Cost Authority: 15XR0680A2 RX191249991000000

Date: 05/19/2015

7.5 Minute Quad Map: Grimes Point Quad, Nevada

Exclusion Category: *516 DM 14.5 D.8 - Renewal of existing grazing, recreation management, or cabin site leases which do not increase the level of use or continue unsatisfactory environmental conditions.*

Nature of Action: The proposed action is for the Bureau of Reclamation to issue permits to Shasta-Cascade Retriever Club and Sierra Nevada Retriever Club (Club) to use portions of land in and around Indian Lakes (Papoose Lake and Twin Lakes) to conduct club hunting dog retriever field trials and hunt tests. In the past, both Clubs have held this event at Harmon Reservoir since 1998 under a permit by Reclamation. This permit has been amended to include the Indian Lakes area. The Hunt Test and Field Trials would be held on two weekends per year from mid-April thru the end of May, with approximately 150 people attending each event.

Some participants will participate in dispersed camping along the shores of the reservoirs but primarily most will overnight in Fallon Nevada. The Clubs provide sani-huts and dumpsters at the event site and ensure all litter is removed in accordance with Federal, State and local laws and regulations. Both clubs plan to organize and participate in pre-event and post-event clean-up days. All portable toilets are required to be a minimum of 300 feet from all surface water sources. The Clubs are restricted to traveling on existing roads and previously disturbed areas. Participants are required to abide by outdoor fire restriction orders. Both Clubs have liability insurance for special uses of Reclamation managed lands in the Newlands Project for these events.

No ground disturbing activities associated with digging or excavation will occur at the camp sites or in the areas where the field trials and hunt tests will occur. Vehicles will remain on established roads.

Timeline: This CEC will cover issuance of the annual permit thru December 31, 2019.

Location: The event is held at Indian Lakes in Churchill County on Reclamation withdrawn land. The legal description for the event is the area surrounding Indian Lakes in the E½ of Section 18, Township 20 North, Range 30 East, M.D.M. and N1/2 of Section 25, Township 20 North, Range 29 East, M.D.M. (Figure 1)

BUREAU OF RECLAMATION
CATEGORICAL EXCLUSION CHECKLIST
 Mid-Pacific Region - Lahontan Basin Area Office

Evaluation of Criteria for Categorical Exclusion

1.	This action would have a significant effect on the quality of the human environment. (40 CFR 1502.3).	<input checked="" type="checkbox"/> No <input type="checkbox"/> Uncertain <input type="checkbox"/> Yes
2.	This action would have highly controversial environmental effects or involve unresolved conflicts concerning alternative uses of available resources [NEPA Section 102(2) (E) and 43 CFR 46.215 (c)].	<input checked="" type="checkbox"/> No <input type="checkbox"/> Uncertain <input type="checkbox"/> Yes
3.	This action will have significant impacts on public health or safety (43 CFR 46.215(a)).	<input checked="" type="checkbox"/> No <input type="checkbox"/> Uncertain <input type="checkbox"/> Yes
4.	This action would have significant impacts on such natural resources and unique geographical characteristics as historic or cultural resources; parks, recreation and refuge lands; wilderness areas; wild or scenic rivers; national natural landmarks; sole or principle drinking water aquifers; prime farmlands; wetlands (E.O. 11990); floodplains (E.O. 11988); national monuments; migratory birds; and other ecologically significant or critical areas (43 CFR 46.215 (b)).	<input checked="" type="checkbox"/> No <input type="checkbox"/> Uncertain <input type="checkbox"/> Yes
5.	The action would have highly uncertain and potentially significant environmental effects or involve unique or unknown environmental risk (43 CFR 46.215 (d)).	<input checked="" type="checkbox"/> No <input type="checkbox"/> Uncertain <input type="checkbox"/> Yes
6.	This action would establish a precedent for future actions or represent a decision in principle about future actions with potentially significant environmental effects (43 CFR 46.215 (e)).	<input checked="" type="checkbox"/> No <input type="checkbox"/> Uncertain <input type="checkbox"/> Yes
7.	This action would have a direct relationship to other actions with individually insignificant but cumulatively significant environmental effects (43 CFR 46.215 (f)).	<input checked="" type="checkbox"/> No <input type="checkbox"/> Uncertain <input type="checkbox"/> Yes
8.	This action would have significant impacts on properties listed, or eligible for listing, on the National Register of Historic Places as determined by the bureau (in coordination with a Reclamation cultural resources professional, RM LND 02-01 D(1)(a)) (43 CFR 46.215 (g)).	<input checked="" type="checkbox"/> No <input type="checkbox"/> Uncertain <input type="checkbox"/> Yes
9.	This action would have significant impacts on species listed, or proposed to be listed, on the List of Endangered or Threatened Species, or have significant impacts on designated Critical Habitat for these species (43 CFR 46.215 (h)).	<input checked="" type="checkbox"/> No <input type="checkbox"/> Uncertain <input type="checkbox"/> Yes

**BUREAU OF RECLAMATION
CATEGORICAL EXCLUSION CHECKLIST
Mid-Pacific Region - Lahontan Basin Area Office**

10.	This action would violate a Federal, State, local, or tribal law or requirement imposed for protection of the environment (43 CFR 46.215 (i)).	<input checked="" type="checkbox"/> No	<input type="checkbox"/> Uncertain	<input type="checkbox"/> Yes
11.	This action would affect ITAs (to be completed by Reclamation official responsible for ITAs) (512 DM 2, Policy Memorandum dated December 15, 1993).	<input checked="" type="checkbox"/> No	<input type="checkbox"/> Uncertain	<input type="checkbox"/> Yes
12.	This action would have a disproportionately high and adverse effect on low income or minority populations (E.O. 12898) (43 CFR 46.215 (j)).	<input checked="" type="checkbox"/> No	<input type="checkbox"/> Uncertain	<input type="checkbox"/> Yes
13.	This action would limit access to and ceremonial use of Indian sacred sites on Federal lands by Indian religious practitioners or significantly adversely affect the physical integrity of such sacred sites (E.O. 13007, 43 CFR 46.215 (k), and 512 DM 3).	<input checked="" type="checkbox"/> No	<input type="checkbox"/> Uncertain	<input type="checkbox"/> Yes
14.	This action would contribute to the introduction, continued existence, or spread of noxious weeds or non-native invasive species known to occur in the area or actions that may promote the introduction, growth, or expansion of the range of such species (Federal Noxious Weed Control Act, E.O. 13112, and 43 CFR 46.215 (l)).	<input checked="" type="checkbox"/> No	<input type="checkbox"/> Uncertain	<input type="checkbox"/> Yes

NEPA Action Recommended: Categorical Exclusion EA EIS

Environmental commitments, explanation, and/or remarks:

See the attached correspondence from the Mid-Pacific Region Cultural Resources Division regarding concurrence with Item 8 (cultural resources), and Indian Trust Assets regarding Item 13.

Reclamation concludes that a Biological Evaluation, Under Section 7 of the Endangered Species Act, is not required for this action. Reclamation determines that this Federal action would have no effect on Threatened or Endangered species.

This CEC authorizes this activity up until the special use permit, authorized by Reclamation, expires (FY2019).

**BUREAU OF RECLAMATION
CATEGORICAL EXCLUSION CHECKLIST
Mid-Pacific Region - Lahontan Basin Area Office**

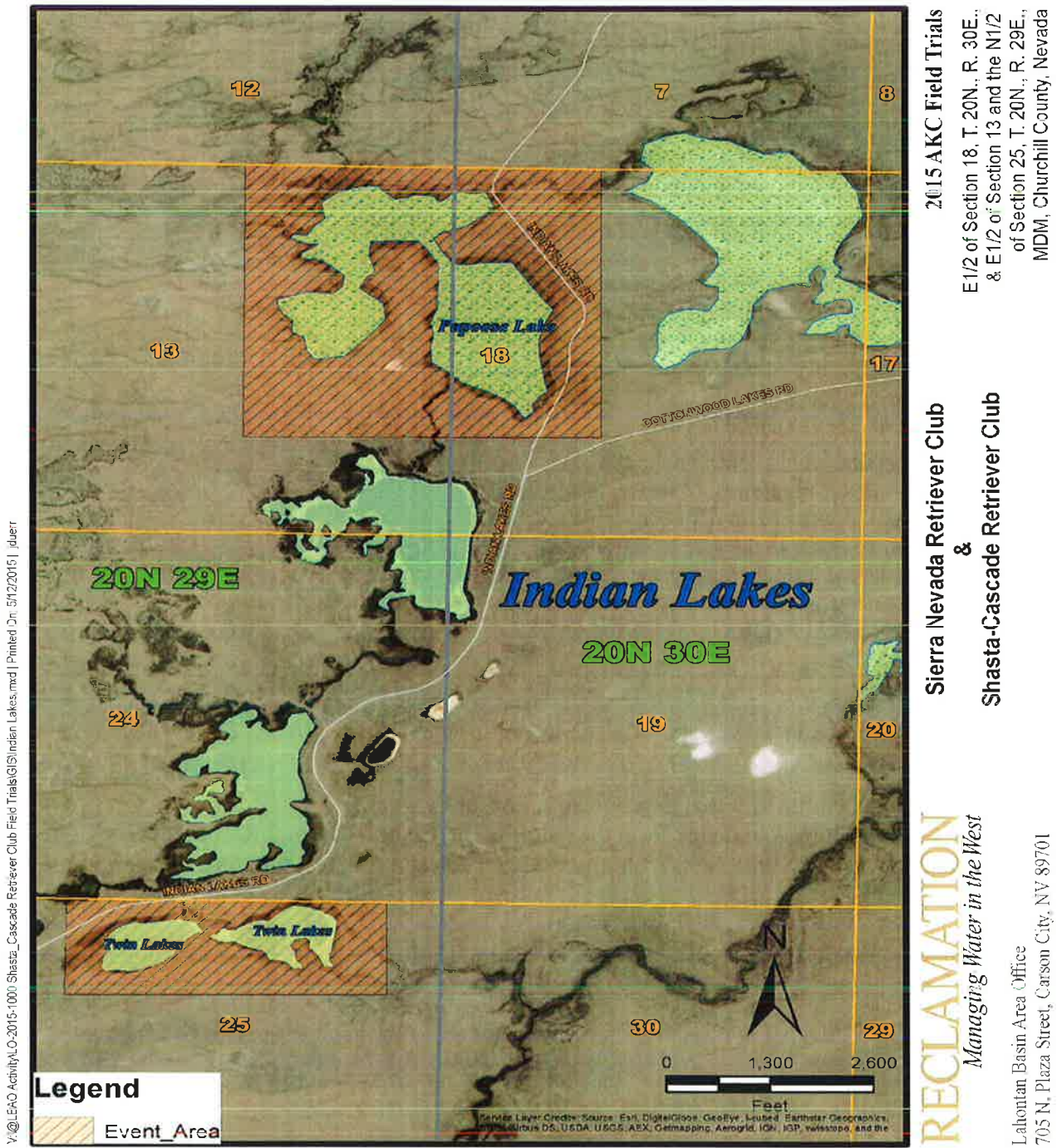

Figure 1 – Indian Lakes

ATTACHMENT A

CULTURAL RESOURCES COMPLIANCE
Division of Environmental Affairs
Cultural Resources Branch (MP-153)

MP-153 Tracking Number: 15-LBAO-144

Project Name: Shasta-Cascade Retriever Club and Sierra Nevada Retriever Club Field Trials

NEPA Document: CEC-LO-2015-2016 and LO-2015-1000

NEPA Contact: Julia Long, Natural Resource Specialist

MP 153 Cultural Resources Reviewer: Scott Williams, Archaeologist 

Date: May 19, 2015

Reclamation proposes issue permits to Shasta-Cascade Retriever Club and Sierra Nevada Retriever Club (Club) to use portions of land in and around Indian Lakes (Papoose Lake and Twin Lakes) to conduct club hunting dog retriever field trials and hunt tests. This is the type of undertaking that does not have the potential to cause effects to historic properties, should such properties be present, pursuant to the NHPA Section 106 regulations codified at 36 CFR § 800.3(a)(1). Reclamation has no further obligations under NHPA Section 106, pursuant to 36 CFR § 800.3(a)(1).

In the past, both Clubs have held this event at Harmon Reservoir since 1998 under a permit by Reclamation. This permit has been amended to include the Indian Lakes area. The Hunt Test and Field Trials would be held on two weekends per year from mid-April thru the end of May, with approximately 150 people attending each event. No ground disturbing activities associated with digging or excavation will occur at the camp sites or in the areas where the field trials and hunt tests will occur. Vehicles will remain on established roads.

Reclamation proposes to permit the event through the issuance of a Land Use Authorization. After reviewing documentation provided within CEC-15-08, Reclamation has concluded this action would not have significant impacts on properties listed, or eligible for listing, on the National Register of Historic Places. This document serves as notification that Section 106 compliance has been completed for this undertaking. Please note that if project activities subsequently change, additional NHPA Section 106 review, including further consultation with the SHPO, may be required.

This document is intended to convey the completion of the NHPA Section 106 process for this undertaking. Please retain a copy in the administrative record for this action. Should changes be made to this project, additional NHPA Section 106 review, possibly including consultation with the State Historic Preservation Officer, may be necessary. Thank you for providing the opportunity to comment.

BUREAU OF RECLAMATION
 CATEGORICAL EXCLUSION CHECKLIST
 Mid-Pacific Region ▪ Lahontan Basin Area Office

ATTACHMENT B

**Indian Trust Assets
 Request Form**

**Submit your request to your office's ITA designee or to MP-400, attention Deputy Regional Resources Manager

Date: May 19, 2015

Requested by	Lahontan Basin Area Office Julia Long, Natural Resource Specialist
Fund	15XR0680A2
WBS	RX191249991000000
Fund/Cost Center	2630000
Region # (If other than MP)	
Project Name	Shasta-Cascade Retriever Club and Sierra Nevada Retriever Club Field Trials
CEC or EA Number	LO-2015-1016 and LO-2015-1000
Project Description	<p>Nature of Action: The proposed action is for the Bureau of Reclamation to issue permits to Shasta-Cascade Retriever Club and Sierra Nevada Retriever Club (Club) to use portions of land in and around Indian Lakes (Papoose Lake and Twin Lakes) to conduct club hunting dog retriever field trials and hunt tests. In the past, both Clubs have held this event at Harmon Reservoir since 1998 under a permit by Reclamation. This permit has been amended to include the Indian Lakes area. The Hunt Test and Field Trials would be held on two weekends per year from mid-April thru the end of May, with approximately 150 people attending each event.</p> <p>Some participants will participate in dispersed camping along the shores of the reservoirs but primarily most will overnight in Fallon Nevada. The Clubs provide sani-huts and dumpsters at the event site and ensure all litter is removed in accordance with Federal, State and local laws</p>

BUREAU OF RECLAMATION
CATEGORICAL EXCLUSION CHECKLIST
 Mid-Pacific Region ▪ Lahontan Basin Area Office

	<p>and regulations. Both clubs plan to organize and participate in pre-event and post-event clean-up days. All portable toilets are required to be a minimum of 300 feet from all surface water sources. The Clubs are restricted to traveling on existing roads and previously disturbed areas. Participants are required to abide by outdoor fire restriction orders. Both Clubs have liability insurance for special uses of Reclamation managed lands in the Newlands Project for these events.</p> <p>No ground disturbing activities associated with digging or excavation will occur at the camp sites or in the areas where the field trials and hunt tests will occur. Vehicles will remain on established roads.</p>
<p>*Project Location (Township, Range, Section, e.g., T12 R5E S10, or Lat/Long cords, DD-MM-SS or decimal degrees). Include map(s)</p>	<p>E½ of Section 18, Township 20 North, Range 30 East, M.D.M. and N½ of Section 25, Township 20 North, Range 29 East, M.D.M.</p>



 Signature

Julia A. Law

 Printed name of preparer

5-19-15

 Date

BUREAU OF RECLAMATION
CATEGORICAL EXCLUSION CHECKLIST
Mid-Pacific Region ▪ Lahontan Basin Area Office

ITA Determination:

The closest ITA to the proposed SHASTA/SIERRA DOG TRIALS activity is the
PALUTE-SHOSHONE TRIBE about 6 miles to the South east
Insert activity name Insert ITA name approx.. compass direction
(see attached image).

Based on the nature of the planned work it does / does not appear to
circle one
be in an area that will impact Indian hunting or fishing resources or water
rights nor is the proposed activity on actual Indian lands. It is reasonable
to assume that the proposed action will / will not have any
circle one
impacts on ITAs.

Rena Ballew
Signature

Rena Ballew
Printed name of approver

5/19/15
Date

**BUREAU OF RECLAMATION
CATEGORICAL EXCLUSION CHECKLIST
Mid-Pacific Region ▪ Lahontan Basin Area Office**

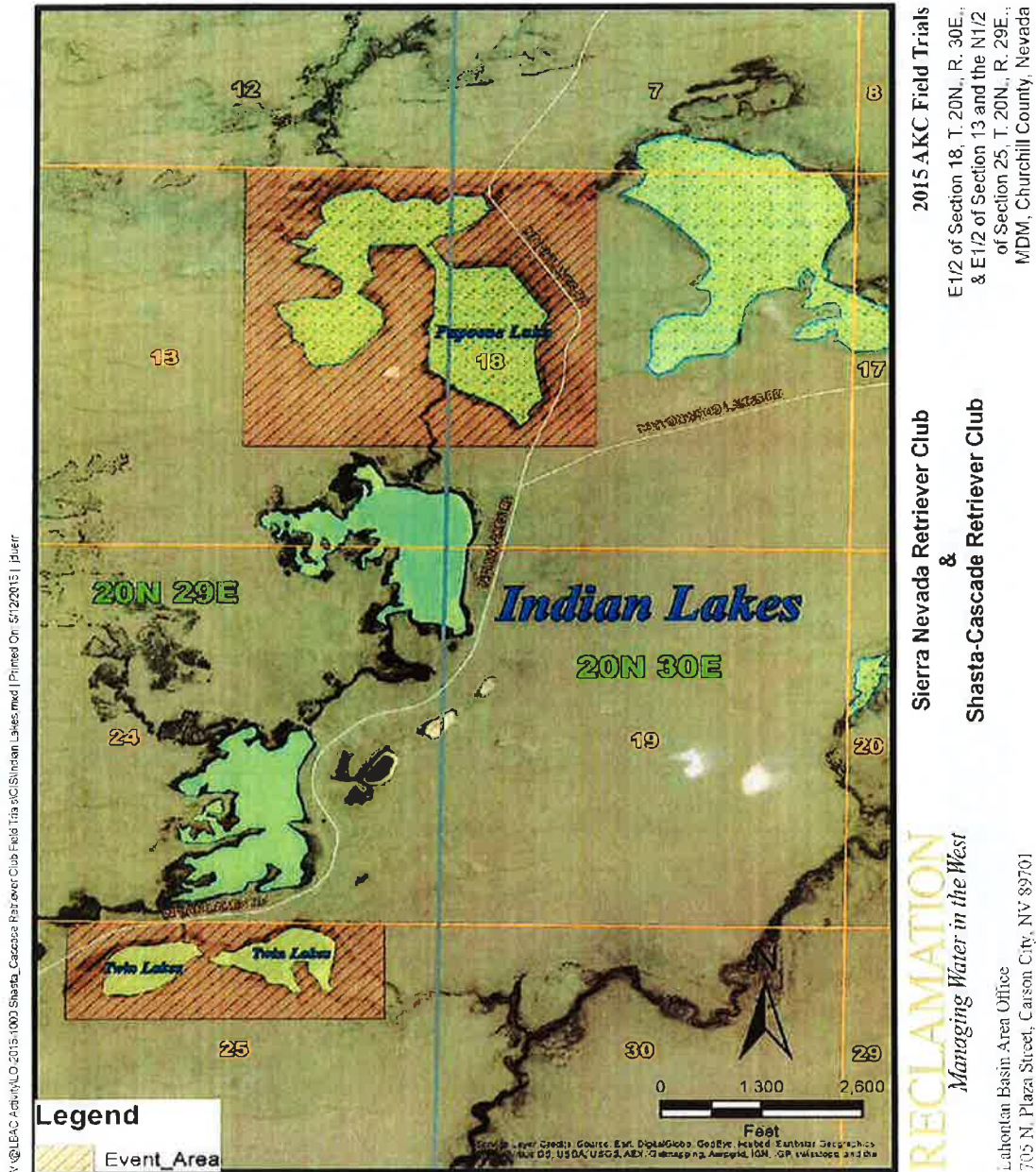
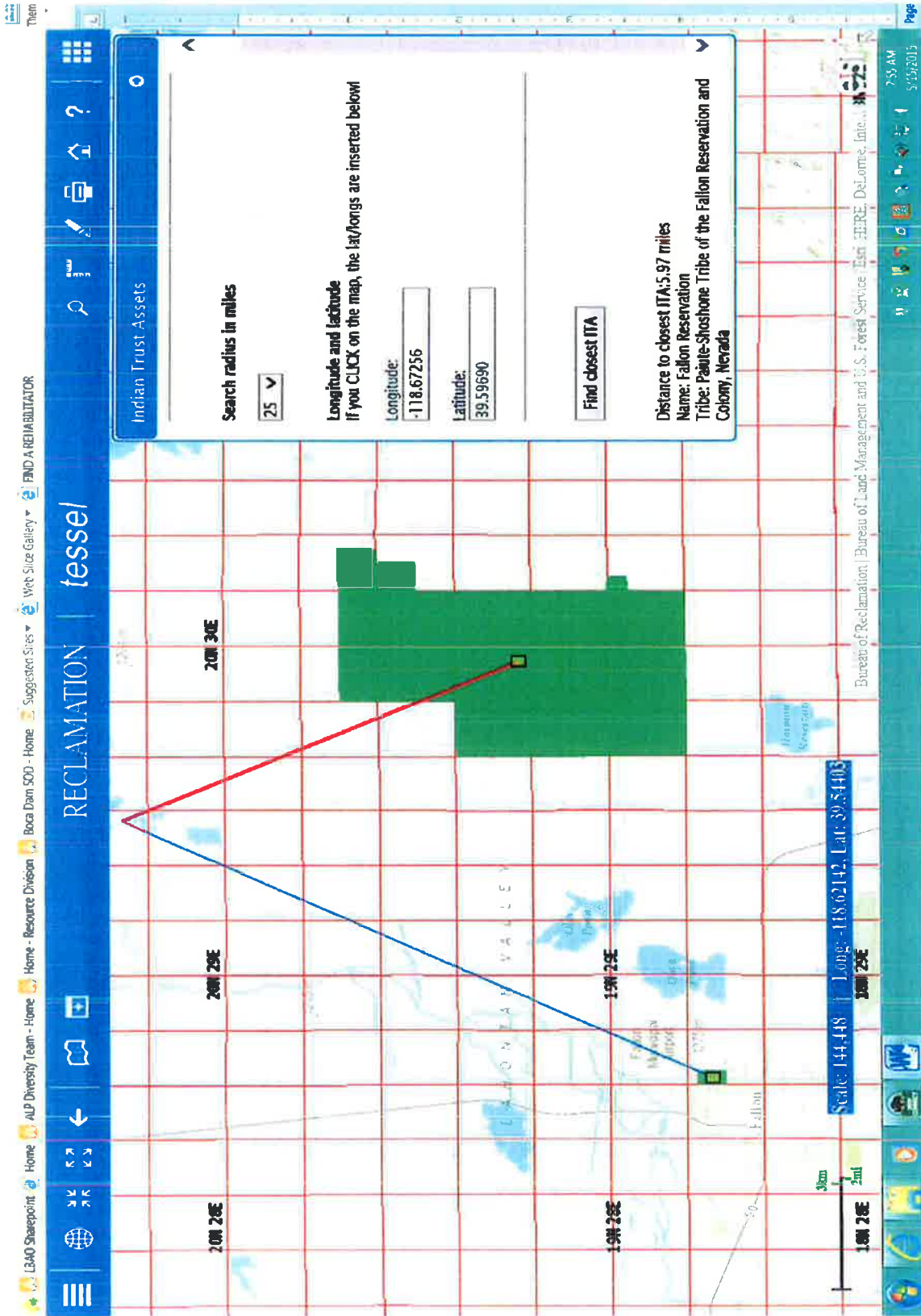

Figure 1 – Indian Lakes

**BUREAU OF RECLAMATION
 CATEGORICAL EXCLUSION CHECKLIST
 Mid-Pacific Region ▪ Lahontan Basin Area Office**



Nearest ITA Location