

# South Delta Improvement Program (SDIP) Staged Decision and Implementation Process

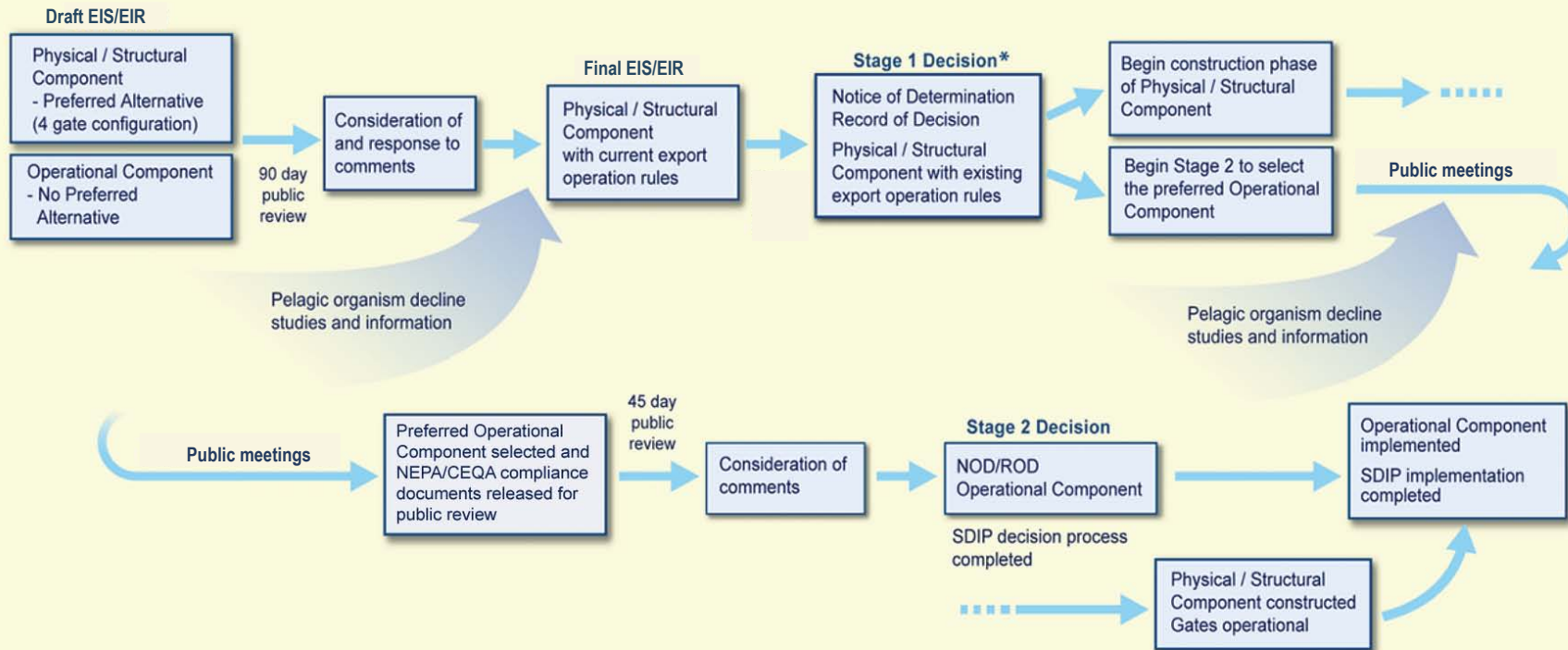

\* Note: It is possible that the No Action Alternative (Existing export operation rules and temporary barriers) would be selected in Stage 1. If this occurs, there would be no construction phase and continuing with a second stage that addresses both the Physical / Structural Component and the Operational Component would be considered.

02053.02.101

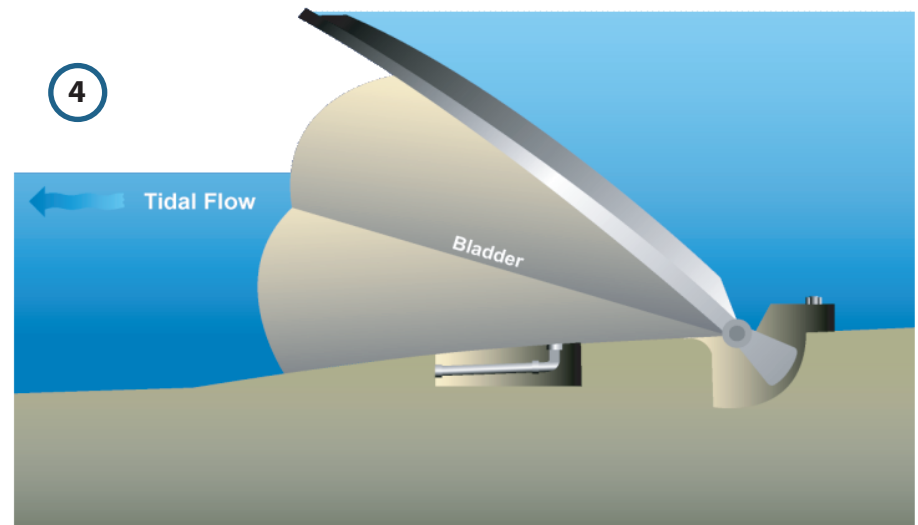
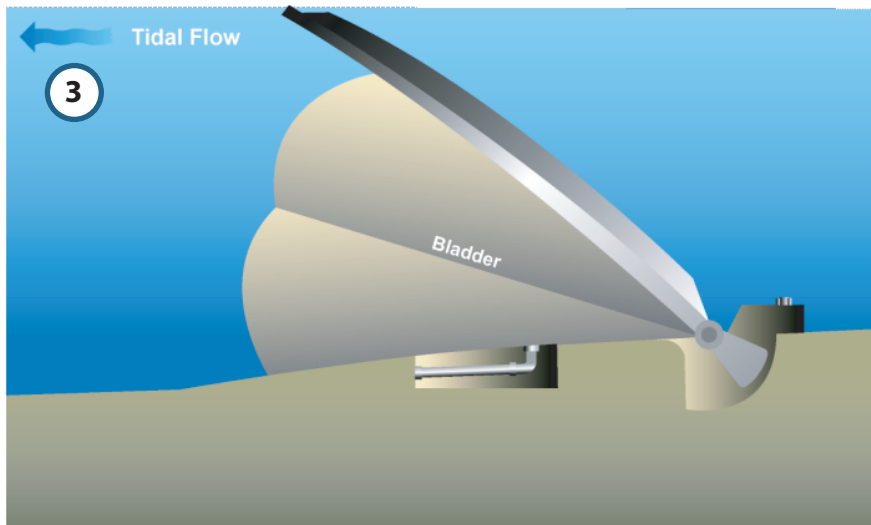
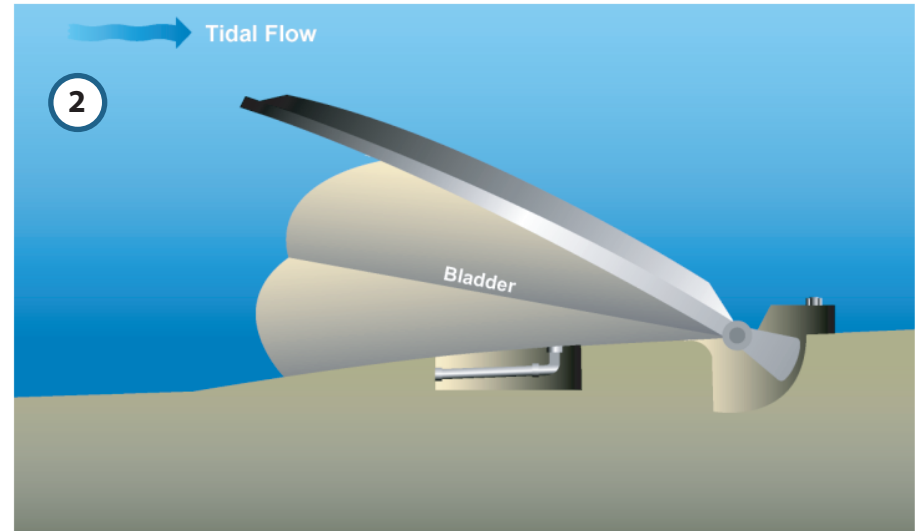
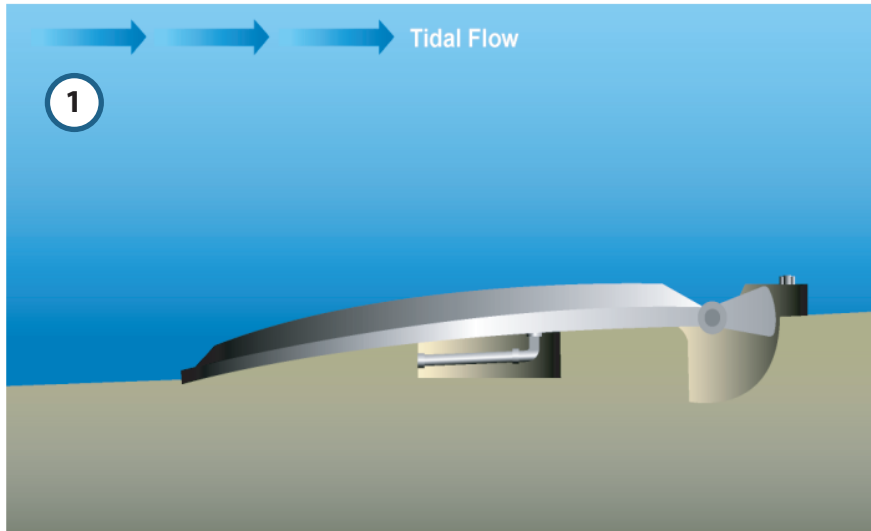

02053.02.101

Source: California Department of Water Resources.

**Figure 2-2**  
**Illustration of Bottom-Hinged Gate Operation**

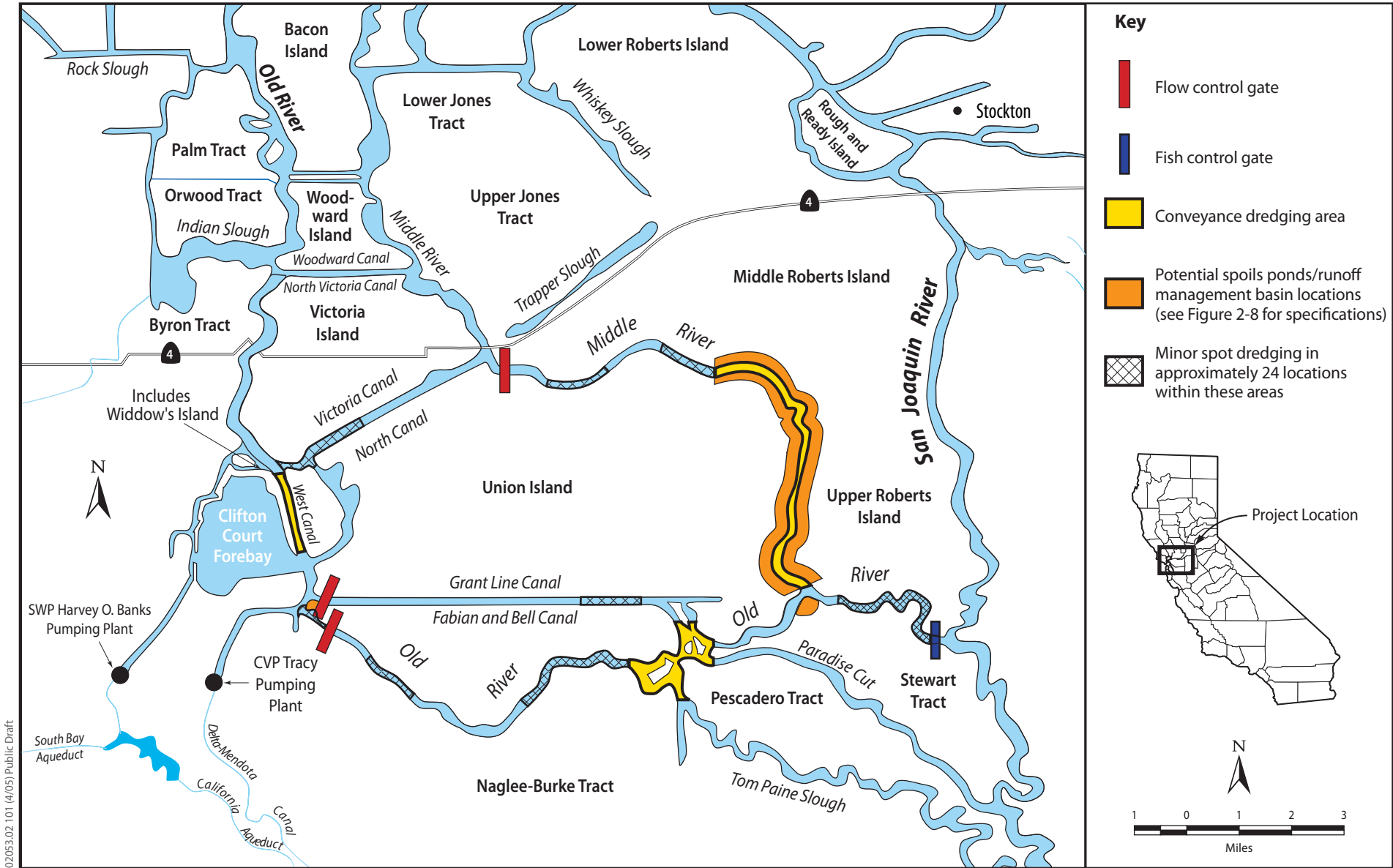

**Figure 2-3**  
**Preferred Physical/Structural Component**

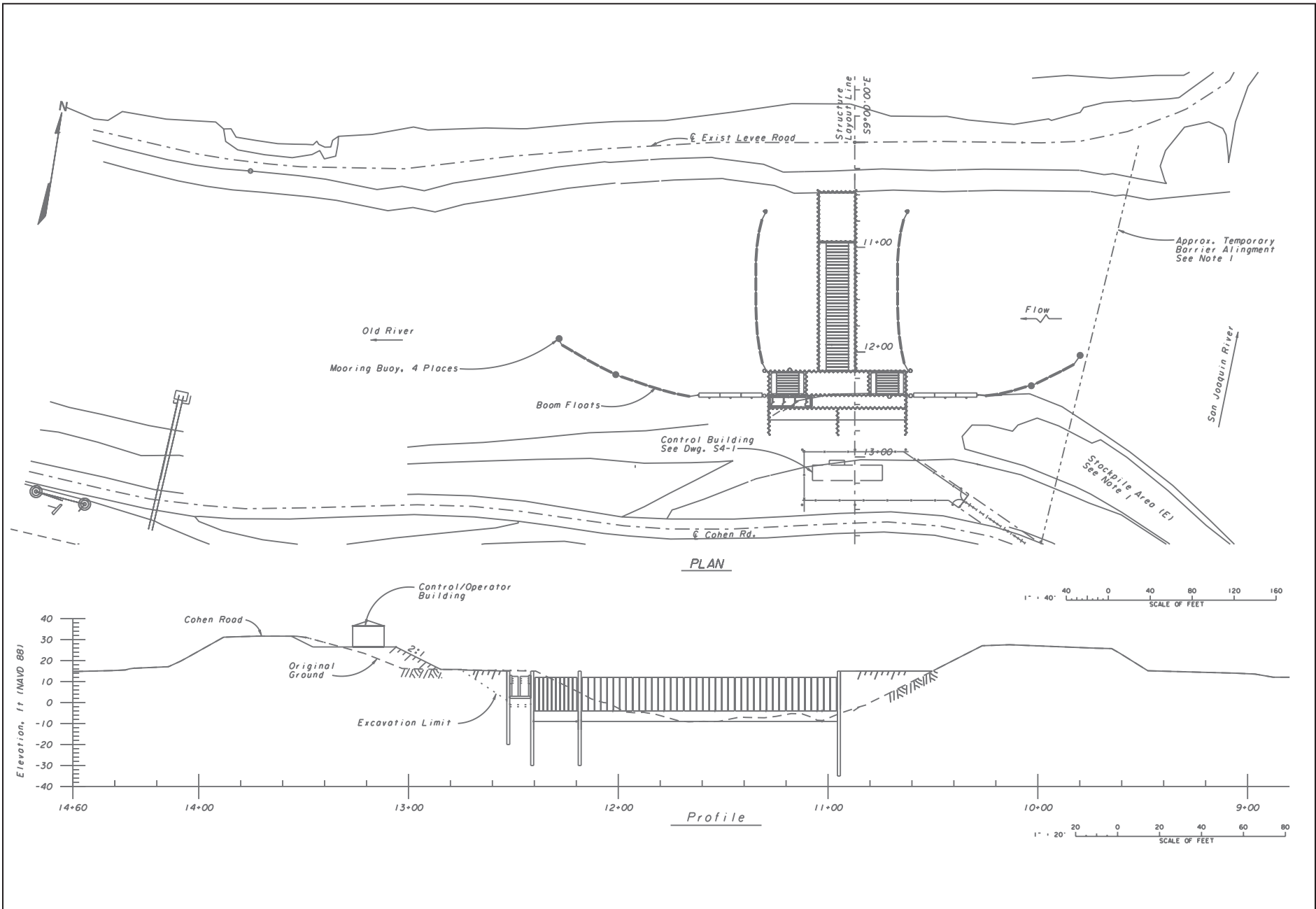

02053.03 (11-04)



Source: California Department of Water Resources.

02053.02.101 (1/05) Public Draft

**Figure 2-4b**  
**Head of Old River**  
**Artist's Rendering (Looking Northward)**

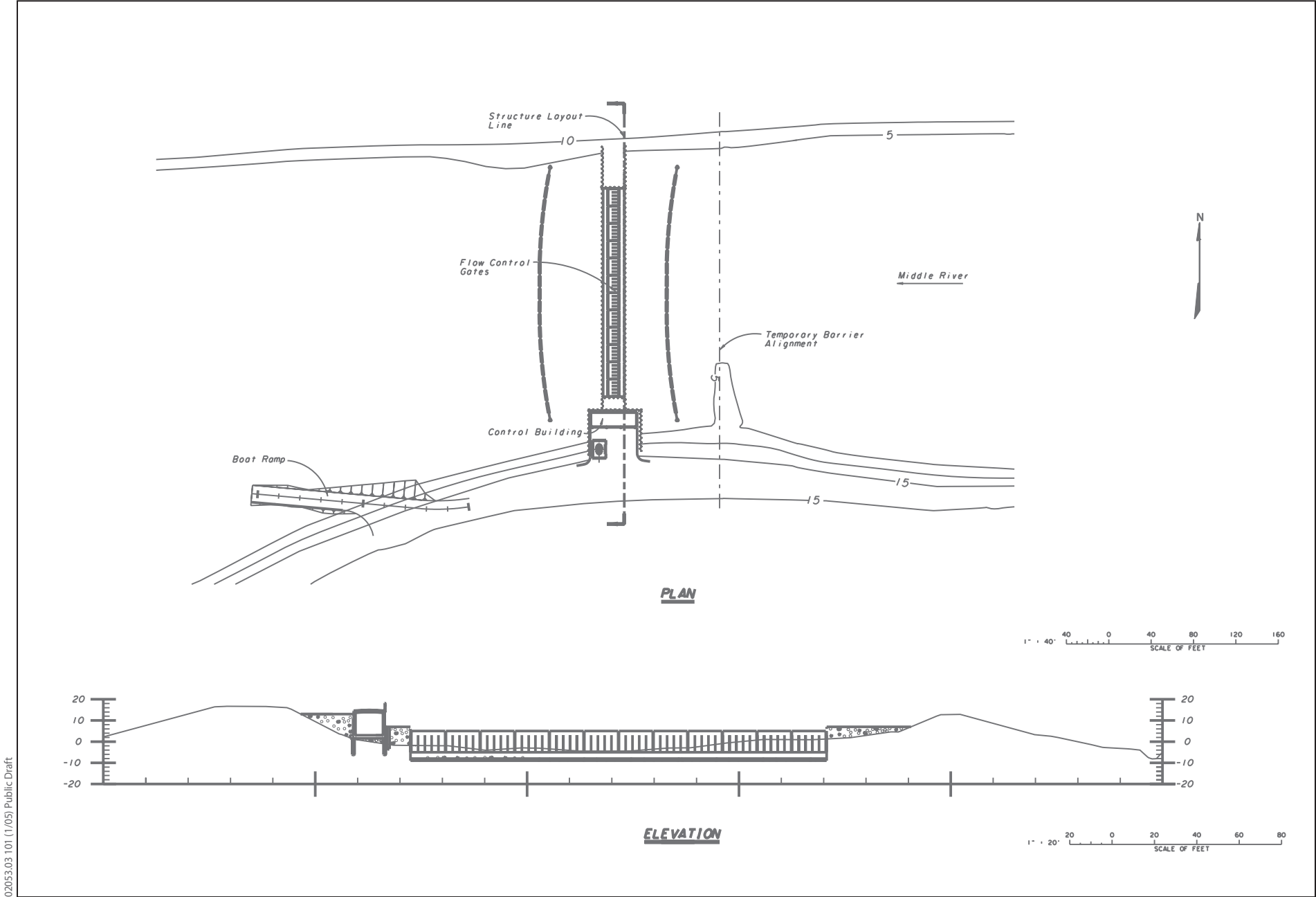

02053.03.101 (1/05) Public Draft

**Figure 2-5a**  
**Middle River Gate Drawing**



Source: California Department of Water Resources.

02053.02.101 (1/05) Public Draft

**Figure 2-5b**  
**Middle River**  
**Artist's Rendering (Looking Northward)**